

Parts Chart for the Wedge® Direct-Inject™ Tree Injection Unit and Accessories (Parts are not shown to scale)

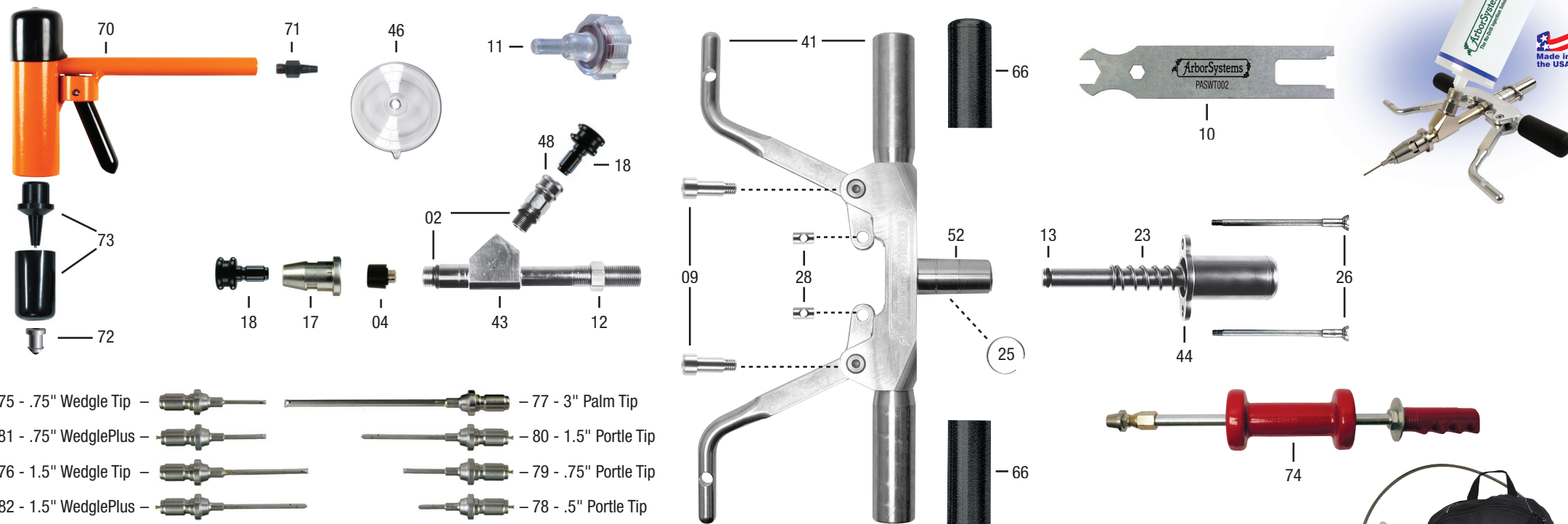

- 75 - .75" Wedgle Tip
- 81 - .75" WedglePlus
- 76 - 1.5" Wedgle Tip
- 82 - 1.5" WedglePlus
- 77 - 3" Palm Tip
- 80 - 1.5" Portle Tip
- 79 - .75" Portle Tip
- 78 - .5" Portle Tip

#	Part #	Description	#	Part #	Description
02	PASW202	QC Coupler Outer O-Ring	73	PAWP73	WedgeChek Adapter, Rubber Sleeve
	PASW203	QC Coupler Inner O-Ring (not shown)	74	PAWP270	Tip Setter
04	PASW204	Replaceable Outlet Check Valve	75	Wedge.75	.75" Wedgle Tip
09	PASW209	Screw Lever Pivot	76	Wedge1.5	1.5" Wedgle Tip
10	PASWT002	Multi-purpose Tool	77	Palm3	3" Palm Tip
11	PASWT003	Garden Hose Adapter	78	Portle.5	.5" Portle Tip
12	PASW12	Lock Nut	79	Portle.75	.75" Portle Tip
13	PASW13	Piston O-Ring	80	Portle1.5	1.5" Portle Tip
17	PASW217	Front QC Coupler	81	WedgePlus.75	.75" WedglePlus Tip
18	PASW218	Dust Plugs	82	WedgePlus1.5	1.5" WedglePlus Tip
23	PASW23	Piston Spring		PASWK201	Annual Maintenance Kit
25	PASW25	Dose Adjustment Ring			(1) Piston O-Ring—#13
26	PASW226	Piston Connector Rod			(2) QC Coupler Outer O-Rings—#02
28	PASW28	Lever Nut			(2) QC Coupler Inner O-Rings—#03
41*	PASW241	Handle and Lever Assembly			(1) WedgeChek Punch Tip—#71
43	PASW243	Main Body		PASWK203	Annual Maintenance Kit for units with Replaceable Outlet Check Valve
44	PASW244	Piston and Cap Piece			(1) Piston O-Ring—#13
46	PASW246	Deflector Shield			(1) QC Coupler Outer O-Rings—#02
48	PASW248	Top QC Coupler			(2) QC Coupler Inner O-Rings—#03
52		.5 ml Dose Adjustment Groove			(1) WedgeChek Punch Tip—#71
66	PASW66	Rear Hand Grips			(1) Replaceable Outlet Check Valve—#04
70	PAWP70	WedgeChek Punch (includes 70, 71, 73)		PASWK202	Small Parts Kit
71	PAWP71	WedgeChek Punch Tip			(1) Dose Adjustment Ring—#25
72*		WedgeChek™			(1) Piston Connector Rod—#26
					(1) Screw Lever Pivot—#09
					(1) Lever Nut—#28

*Not sold separately.

High-Volume Kit (Sold separately)

Make up to 1000 injections without reloading chemical. Simply attach the hose to the Wedge Direct-Inject unit and the 1000 ml chemical pack, prime, and inject. No other tools, equipment, or power supply are needed.

1. Remove the yellow cap from the hose guide by unscrewing. Remove the adaptor sleeve from inside the hose guide.
2. Slide the High-Volume hose through the yellow cap and into the hose guide, pulling the hose through the chemical pack cage and out the top of the backpack.



3. Attach the hose to a 1000 ml chemical pack using the same method as you attach a 120 ml chemical pack to the injection unit (see instruction on page 1).

4. Carefully pull the hose and chemical pack into the cage inside the backpack until the chemical pack rest snugly against the hose guide.

5. Secure the chemical pack in the cage with the closure pin.
6. Place the adaptor sleeve over the hose and slide the sleeve into the hose guide.

7. Screw the yellow cap onto the hose guide and hand tighten.

8. Attach the hose to the top QC coupler on the injection unit.

9. Prime and you are ready to begin injecting.

